



## COMPANY PROFILE

## SUMMARY

### WHO WE ARE

KEY NUMBERS  
OUR CIRCULAR MISSION  
OUR MULTIDISCIPLINARY TEAM  
CUSTOMERS AND PARTNER

### WHAT WE DO

WHERE WE ARE  
SERVICES  
OWAC FOR **NRRP**  
INNOVATION  
BIM  
CERTIFICATES



OWAC, acronym for Open Water Company, is an engineering company that operates within the **ENVIRONMENTAL** sector developing circular economy initiatives that have true impact on people's lives and the Planet

Thanks to the expertise acquired for over two decades and our constant research for technological progress we have become a highly specialised engineering company when it comes to designing multifunctional industrial platforms. An **EFFICIENT WORKFLOW** that minimises indetermination margins is achieved by integrating different technologies, using advanced control systems and supporting interoperability during project development

*"DEL CARATTERE DEGLI ABITANTI  
D'ANDRIA  
MERITANO DI ESSERE RICORDATE  
DUE VIRTÙ:  
**LA SICUREZZA IN SÉ STESSI  
E LA PRUDENZA.**  
CONVINTI CHE  
OGNI INNOVAZIONE NELLA CITTÀ  
INFLUISCA SUL DISEGNO DEL CIELO  
PRIMA D'OGNI DECISIONE  
**CALCOLANO I RISCHI E I VANTAGGI**  
PER LORO E PER  
L'INSIEME DELLE CITTÀ E DEI MONDI"*

ITALO CALVINO, LE CITTÀ INVISIBILI

IN 2020 OWAC  
WAS AWARDED THE  
NATIONAL PRIZE  
**“100 ECCELLENZE  
ITALIANE”**

PROMOTED BY  
THE PRESIDENCY OF THE  
COUNCIL OF MINISTERS,  
FOR THE REMARKABLE  
ENGINEERING SERVICES  
PROVIDED





## WASTE TO ENERGY INTEGRATED PLANTS

Energy independency has become a major strategic factor for all nations. **WASTE TO ENERGY** industrial platforms support circular economy systems allowing the **VALORIZATION OF WASTE** and the recovery of secondary materials

The transition to sustainability requires a **SYSTEMIC RECONVERSION OF DESIGN METHODOLOGIES**. The solutions adopted to mitigate the development of such projects, lead to choices that take into account different elements such as combining the technical needs of production with the carefulness towards the natural or anthropized surroundings



THE USE OF THE BIM METHODOLOGY ENABLES A CONTINUED **CONTROL AND ANALYSIS** OF THE PROJECTS LIFE CYCLES, FROM CONCEPTUAL PHASES TO MONITORING AND OPERATIONAL PHASES, DOWN TO DEMOLITION AND THE RECOVERY OF REUSABLE MATERIALS (LCA)

## WHO WE ARE

OWAC is a leading engineering company specialised in waste treatment and **waste to energy**, environmental remediation, water treatment and renewable energy

Our services cover all project phases and its entire lifecycle

We use BIM methodology and advanced monitoring systems to reduce risks and costs while securing quality control and compliance with regulatory and legal requirements.

KEY NUMBERS

OUR CIRCULAR MISSION

OUR MULTIDISCIPLINARY TEAM

CUSTOMERS AND PARTNERS

**KEY NUMBER**

We work within the environmental engineering framework and use cutting-edge technologies to develop **CIRCULAR ECONOMY** systems that aim to raise energy efficiency, integration and sustainability

All our activities are oriented towards **ECO SUSTAINABLE PROJECTS** that contribute to reduce non recyclable materials, create value from recyclables and preserve the Planet



**18**

countries served



**45**<sub>ML</sub>

user served



**70**<sub>ML</sub>

hours of engineering

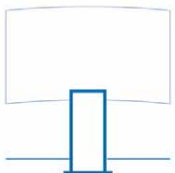

**18**

expo / meeting



**171**<sub>MLN€</sub>

NRRP project

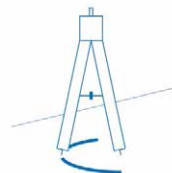

**240**<sub>MLN€</sub>

work in progress

## OUR CIRCULAR MISSION

*“SOME CHANGES ARE SO  
**SLOW**,  
YOU DON'T NOTICE THEM,  
OTHERS ARE SO **FAST**,  
THEY DON'T NOTICE YOU”*

ASHLEIGH BRILLIANT

**Think green\_act circular**, thoughts and actions walk together and reinforce each other to create a **NEW DEVELOPMENT MODEL** that holds the planet and human well-being at heart, and is in line with the sustainable goals set by the United Nations

We recognize today's environmental problems and we believe in the need of a drastic mitigation of carbon emissions, the reduction of the exploitation of raw materials and the balance of environmental principles, The solution is a multidisciplinary approach that brings together innovation, entrepreneurial development and social responsibility

The company's **AMBITION** is to support the development of a thriving sustainable world from an environmental, social and economic perspective





## OUR MULTIDISCIPLINARY TEAM

A constant approach towards innovation coupled with great teamwork have led to recognized excellency levels. Our most important resource to generate change is **PEOPLE**, their multidisciplinary skills and their energy

OWAC is the acronym for Open Water Company. As stated by the Founder and CEO Rocco Martello: «Imagining vast and mutable horizons, such as the marine environment, trains us daily to solve problems dynamically, competently and flexibly, and prepares us to new learnings and to technological progress". We take great care of human capital and **SHARED KNOWLEDGE**, which, through slow stratification and daily commitment, is transferred to new arrivals

The international presence of the company and the ongoing relationship with research institutes, escalates continuous inhouse competences and strengthens the skills of external consultants, most of whom have been working with us for years

Today, OWAC counts with over 50 specialised professionals that enable high quality results and provide customers **WITH PRIME SOLUTIONS AND DESIGNS**. An integrated workflow is achieved by using advanced technologies and interconnected digital solutions for data management



## ORGANIZATION CHART

### MANAGING DIRECTOR

**Rocco Martello**

CEO

eng. Carlo Butticè **BIM MANAGER\_CIVIL**  
eng. Liborio Ardizzone **ENERGY AND ENVIRONMENT**  
archit. Francesco Briguglia **ARCHITECTURE**  
eng. Riccardo Molteni **INDUSTRIAL PROCESSES**  
eng. Massimo Bonomo **MECHANICAL**  
eng. Maurizio Migliorino **ELECTRICAL**  
eng. Giovanni Cangemi **AUTOMATION**  
geol. Carmelo Ferla **GEOLOGY**

### Technical departments

Environment  
Waste treatment  
Remediation  
Decommissioning  
Industrial  
Civil  
Architecture  
Structure  
Operation & Maintenance  
Survey Monitoring  
Geology  
Geotechnics  
Hydraulics  
Energy Electric  
Site Management  
Plants Management  
Research & Development  
Landscape Architecture  
Automation  
Building Information Modeling

### Management and administration departments

Administration  
Tender  
Legal Affairs  
Human Resources  
Audit and quality management  
Commercial  
International relations  
Strategic development







## CUSTOMERS AND PARTNERS

To overcome new global challenges that require taking sensible and measured actions, we believe in **SYNERGIES** and international cooperation. This is why we have strengthened networks, agreements and important partnerships and work together with research institutions, universities and government agencies to daily and collectively build progress

Owac has an important bilateral agreement with the Sino-Italian Centre for Environmental Sustainability **SICES** in Shanghai, born from the alliance between the Italian and Chinese Ministries for the Environment, with the aim of promoting multilateral sustainable development projects





Recently we have established an operational office within the Tongji University of Shanghai

With the University of Palermo (UNIPA) and the University of the South Pacific (USP) we are working on solutions to implement sustainable energy projects in the small Islands of the Pacific





## WHAT WE DO

We design sustainable, efficient and innovative solutions within the field of environmental engineering

Our waste to energy plants produce energy, enable the reuse of materials, reduce CO<sub>2</sub> emissions, and minimise waste to landfill

SERVICES  
OWAC FOR **NRRP**  
INNOVATION  
BIM  
CERTIFICATES

## WHERE WE ARE

We are present in several countries where we collaborate with government institutions and local industry players.

OWAC has its headquarters in Palermo (Italy), and international branches in Africa (Senegal), the United Arab Emirates (Dubai), and China (Shanghai). Advanced communication systems are used to guarantee performance and quality services

With this in mind we have set up the OWAC Environmental Development Hub **OWAC\_EDH**, to connect sector experts, research institutes and the best technology providers and address environmental issues transversally enabling a global approach to projects and research

## SERVICES

Our services cover the entire workflow required when implementing a project, **FROM CONCEPTION DESIGNS TO MONITORING DURING OPERATIONS**. We provide strategic advice to public and private clients for the development of strategies to solve large-scale environmental issues

Constant innovation together with great teamwork enable us to achieve recognized levels of excellency

WE LOOK FOR PEOPLE WHO BELIEVE IN **CHANGE**, WANT TO PARTICIPATE IN THE GLOBAL GREEN TRANSITION AND WHO WANT TO WORK IN SMART AND SUSTAINABLE MANAGEMENT OF RESOURCES.

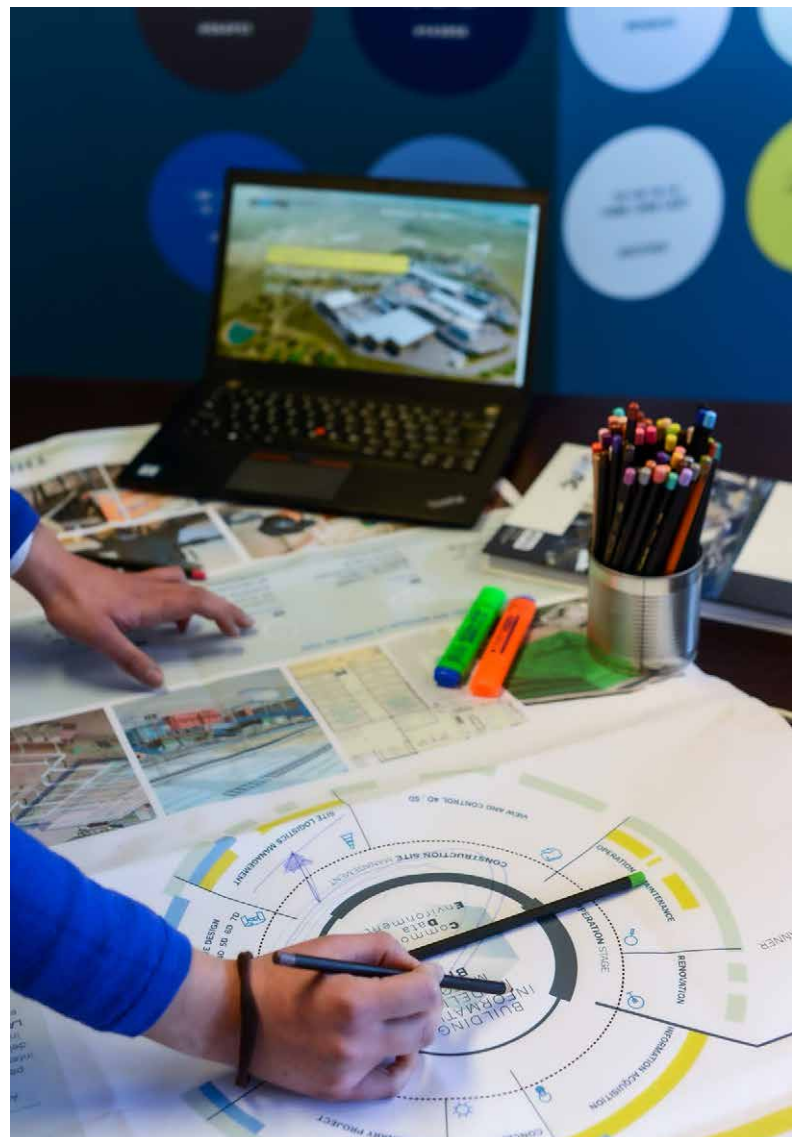



**OWAC**  
**ENGINEERING COMPANY**

**HEADQUARTERS**

PALERMO

DAKAR

**INTERNATIONAL DESK**

SHANGHAI

**COMMERCIAL DESK**

DUBAI



OWAC'S

**COMMITMENT TO THE NATIONAL RECOVERY  
AND RESILIENCE PLAN (NRRP)**

The NRRP recognizes the investments on infrastructure essential for the **DEVELOPMENT** and **COHESION** of all European member states, and provides unprecedented financial resources to be allocated to modernise and rebuild infrastructural assets. Consistent with the strategies adopted by the European Commission, the Plan encourages an integrated development approach that finds synergistic balance between the economic, social and environmental aspects, and the technical elements

With this in mind, the entire system of waste collection, management, waste treatment, recovery and disposal has set new targets:

- reduce the production of waste at the source;
- implement, expand and make the segregated waste collection system more efficient;
- improve waste materials recovery systems;
- promote and make energy recovery systems from waste more efficient;
- minimise residual waste to send to final disposal (landfill)

The entire integrated waste management system therefore, is a clear example of applied circular economy and becomes a fundamental resource, in terms of material and energy recovery, that will benefit the same users who generate the waste



Today, Owac is developing projects within **NRRP** framework for several public and private clients, providing a wide range of integrated industrial platforms and solutions

**Sistema Ambiente Provincia di Napoli S.p.A. (SAPNA) - Municipality of Tufino**

Highly automated project for the modernisation of an existing platform with the integration of a new section of Organic Fraction of Municipal Solid Waste (OFMSW) for the production of quality compost and biomethane

**Sistema Ambiente Provincia di Napoli S.p.A. (SAPNA) - Municipality of Giugliano**

Highly automated project for the modernisation of an existing platform with the integration of a new section of OFMSW for the production of quality compost and biomethane

**Agenzia territoriale della Regione Puglia per il servizio di gestione dei rifiuti S.p.A. (AGER) - Municipality of Lecce**

Integrated anaerobic / aerobic plant for treatment of the OFMSW from separate collection and production of biomethane and quality compost

**Acquedotto Pugliese S.p.A. - Municipality of Foggia**

Biogas and biomethane production plant from biomass source (sludge from the biological purification process)

**Salerno Pulita S.p.A. - Municipality of Salerno**

Biogas production plant and treatment for the OFMSW

**Asja Ambiente Italia S.p.A. - Municipality of Castellana Sicula**

Waste to energy plant for the production of quality compost and biomethane from the OFMSW and valorisation of the residual fraction

**Asja Ambiente Italia S.p.A. - Municipality of Mazzarrà Sant'Andrea**

Waste to energy plant for the production of quality biomethane and compost with material recovery from the treatment of urban waste

**Asja Ambiente Italia S.p.A. - loc. Bellolampo - Municipality of Palermo**

Waste to energy plant for the production of biomethane from the organic fraction coming from the plant of mechanical biological treatment of MSW and production of biomethane from the OFMSW deriving from the separate collection

**ASIA Napoli S.p.A. - Municipality of Napoli**

Highly automated plant with low human resources needed for the segregation, valorisation and recycling of waste paper and cardboard

**Sistema Ambiente Provincia di Napoli S.p.A. (SAPNA) - Municipality of Caivano**

Highly automated plant with low human resources needed for the segregation, valorisation and recycling of waste paper, cardboard and glass









## INNOVATION

We adopt cutting-edge technologies that make our processes continuously more efficient

Technological innovation is one of our main levers to create value. Thanks to an innovative and standardised design methodology, We are able to meet high quality international standards

To have an integrated design approach we use **BIM** methodology, **DRONES AND LASER SCANNER** for the monitoring and surveys and **DIGITAL TWIN** models for final design phases and work supervision

Today, Owac is one of the first companies certified UNI / PdR 74: 2019 for **ARCHITECTURAL DESIGN, STRUCTURAL AND INSTALLATION WITH METHODOLOGY BIM**; the inhouse presence of BIM MANAGERS, BIM COORDINATORS and BIM SPECIALISTS guarantees a well-equipped BIM certified team specialised on information digital processes management, construction and modelling, in compliance with

### UNI 11337-7 STANDARD

OWAC holds ISO 9001 certifications for the design and construction management in the industrial sector and is an Accredited **ENERGY SERVICE COMPANY (ESCo)**.

Furthermore, the team holds CERTING certifications for "waste treatment and disposal - remediation projects - industrial wastewater treatment plants " and the team are recognized national experts by PdR / UNI 13: 2019 - **ITACA** protocol



In line with the national industrial policy, which aims at providing substantial changes by encouraging investments in technological innovation, OWAC guarantees the **DIGITIZATION OF PRODUCTION PROCESSES** by foreseeing machinery and technologies compliant with the provisions of the National Plan INDUSTRY 4.0 approved on 21 September 2016

Thanks to the **INTEGRATION AND INTERCONNECTION** between subjects, machinery and devices, we combine physical and virtual worlds to use data and information efficiently, and allow the development of smart and fully digitalized models of production

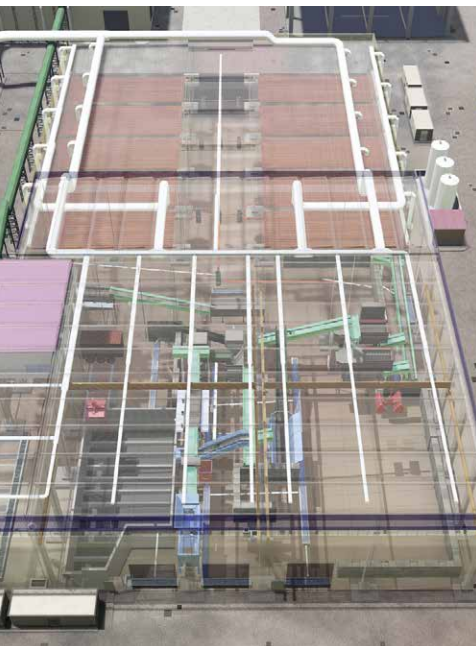

## Building Information Modeling



UNI PdR 74:2019  
21042BIM

**BIM** (Building Information Modeling) is an integrated method of work, supported by software's, which allows to integrate in a single digital model, the entire lifecycle of a project - making the reports, designs, economic data, and contracts always available and interconnected allowing to **CHECK AND ANALYSE THE LIFE CYCLE** using intelligent models, from design to monitoring in the operational phases, up to demolition and recovery of reusable materials.

The adoption of the BIM methodology for the development of projects is increasingly required, sometimes mandatory. We use BIM with a **STRUCTURED APPROACH**, optimising internal design processes and execution of orders, ensuring a reduction of inconsistencies, costs and production times

Thanks to an open platform for sharing the project and the collaborative interoperability methods, each figure involved has the necessary tools to plan, design and build more efficiently

DUE TO THE BIM METHODOLOGY, OUR **WORKFLOW IS FULLY DIGITALIZED**, ENABLING TO SPEED UP THE DESIGN PROCESS, CONSTRUCTION AND COMMISSIONING PHASES AND SUPPORT O&M, **REDUCING COSTS** AND UNPREDICTED SITUATIONS

The use and integrate cutting-edge technologies, such as drones during surveys and monitoring phases and advanced control devices, such as virtual reality systems, allows to **CUT DOWN THE MARGIN OF ERROR AND GUARANTEE THE REDUCTION OF MANAGEMENT COSTS**

Our business-oriented approach and our trained multidisciplinary team enables the company to offer optimal solutions that meet market needs and respond effectively to current environmental concerns

We guarantee a **COMPLETE AND CERTIFIED BIM SERVICE** within the digital information management processes, construction and BIM modelling, in accordance with the **UNI 11337-7 STANDARD**





**OWAC WORKFLOW**  
**BUILDING INFORMATION MODELING (BIM)**  
 METHOD

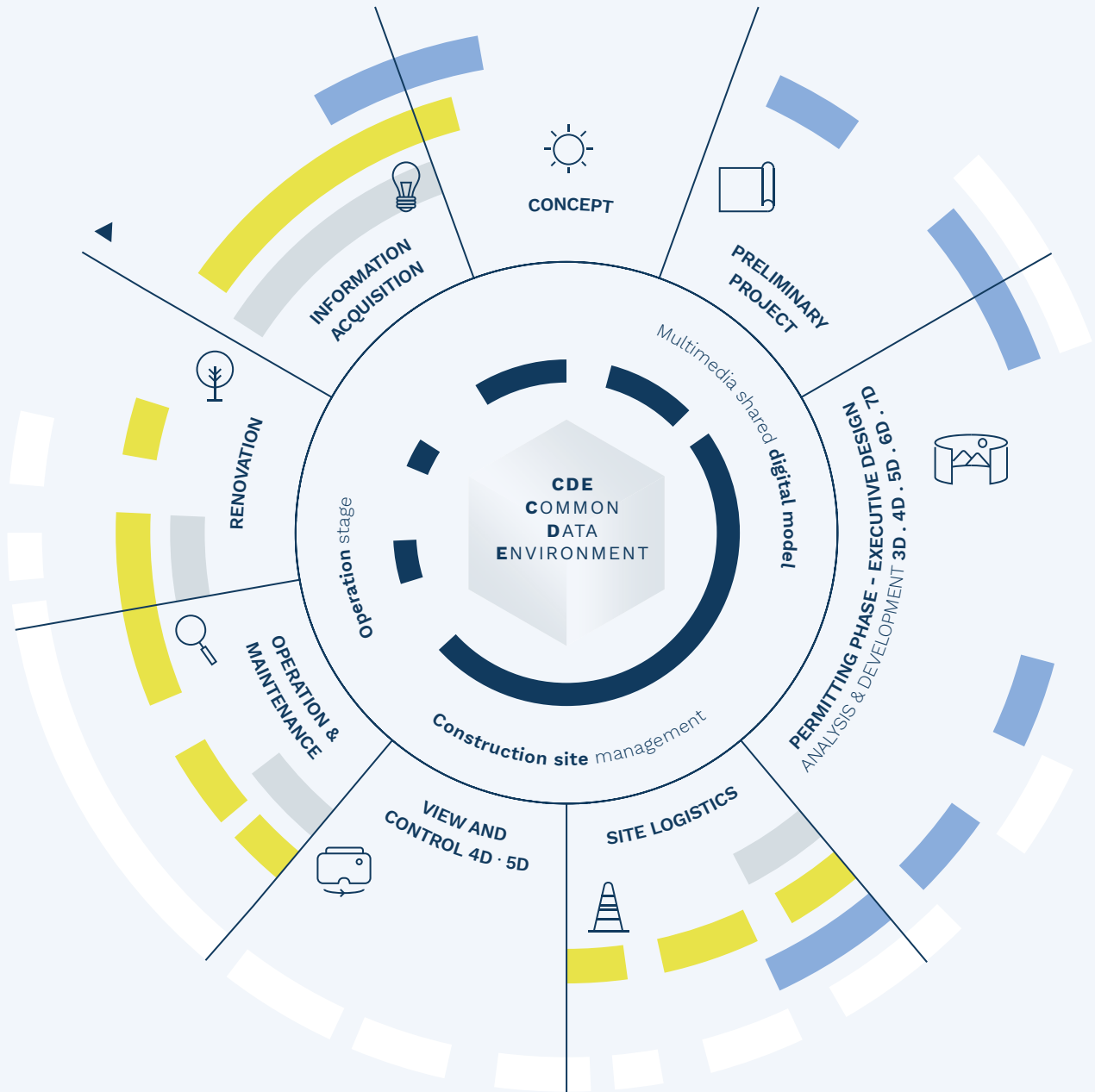

- DRONI
- LASER SCANNER
- VIRTUAL REALITY
- MIXED REALITY
- BIM MODELING



CISQ is a member of



The International Certification Network  
www.iqnet-certification.com

**CERTIFICATO N. 30233/14/S**  
**CERTIFICATE No.**

SI CERTIFICA CHE IL SISTEMA DI GESTIONE PER LA QUALITÀ DI  
*IT IS HEREBY CERTIFIED THAT THE QUALITY MANAGEMENT SYSTEM OF*

**OWAC ENGINEERING COMPANY S.R.L.**

VIA RESUTTANA, 360 90146 Palermo (PA) ITALIA  
NELLE SEGUENTI UNITÀ OPERATIVE / *IN THE FOLLOWING OPERATIONAL UNITS*

VIA RESUTTANA, 360 90146 Palermo (PA) ITALIA E CANTIERI OPERATIVI

È CONFORME ALLA NORMA / *IS IN COMPLIANCE WITH THE STANDARD*

**ISO 9001:2015**

E AL REGOLAMENTO TECNICO ACCREDIA RT-21, APPLICABILE IN ITALIA  
PER I SEGUENTI CAMPI DI ATTIVITÀ / *FOR THE FOLLOWING FIELD(S) OF ACTIVITIES*

EROGAZIONE DI SERVIZI DI PROJECT MANAGEMENT. PROGETTAZIONE IN AMBITO CIVILE E INDUSTRIALE CON APPLICAZIONE DI METODOLOGIA BUILDING INFORMATION MODELLING (BIM). DIREZIONE LAVORI. VERIFICHE SULLA PROGETTAZIONE DELLE OPERE AI FINI DELLA VALIDAZIONE/APPROVAZIONE, AI SENSI DELLA NORMATIVA VIGENTE.

IAF:34

*PROVISION OF SERVICES OF PROJECT MANAGEMENT. DESIGN IN THE CIVIL AND INDUSTRIAL FIELD WITH BUILDING INFORMATION MODELING METHODOLOGY APPLICATION (BIM). SUPERVISION OF WORKS. CHECK OF WORKS DESIGN FOR VALIDATION/APPROVAL IN ACCORDANCE WITH CURRENT LEGISLATION.*

La validità del presente certificato è subordinata a sorveglianza periodica annuale / semestrale ed al riesame completo del sistema di gestione con periodicità triennale

*The validity of this certificate is dependent on an annual / six monthly audit and on a complete review, every three years, of the management system*

L'uso e la validità del presente certificato sono soggetti al rispetto del documento RINA: Regolamento per la Certificazione di Sistemi di Gestione per la Qualità

*The use and validity of this certificate are subject to compliance with the RINA document : Rules for the certification of Quality Management Systems*

Prima emissione <i>First Issue</i>	12.02.2014	Data decisione di rinnovo <i>Renewal decision date</i>	10.02.2020
Data scadenza <i>Expiry Date</i>	11.02.2023	Data revisione <i>Revision date</i>	19.10.2022

Maurizio Mazzapicchi

Catania & Palermo Management  
System Certification, Head



www.cisq.com



SGQ N° 002 A

Membro degli Accordi di Mutuo Riconoscimento EA, IAF e ILAC  
Signatory of EA, IAF and ILAC Mutual Recognition Agreements

**RINA Services S.p.A.**  
Via Corsica 12 - 16128 Genova Italy

CISQ è la Federazione Italiana di Organismi di Certificazione dei sistemi di gestione aziendale  
*CISQ is the Italian Federation of management system Certification Bodies*

Form CER/BSGE-2022



**CERTIFICATO N.**  
**CERTIFICATE No.** **103/19/ESCO**

SI CERTIFICA CHE L'ORGANIZZAZIONE  
*IT IS HEREBY CERTIFIED THAT THE ORGANISATION*

**OWAC ENGINEERING COMPANY S.R.L.**

VIA RESUTTANA, 360 90146 PALERMO (PA) ITALIA

NELLE SEGUENTI UNITA' OPERATIVE / *IN THE FOLLOWING OPERATIONAL UNITS*

VIA RESUTTANA, 360 90146 Palermo (PA) ITALIA

E' CONFORME ALLA NORMA / *IS IN COMPLIANCE WITH STANDARD*

**UNI CEI 11352:2014**

Schema di certificazione secondo la circolare ACCREDIA elaborata ex art. 12 comma 1 del D. Lgs. 4 luglio 2014, n. 102, approvato con Decreto Interministeriale (Ministero dello Sviluppo Economico e Ministero dell'Ambiente e della Tutela del Territorio e del Mare) del 12 Maggio 2015

PER IL SEGUENTE CAMPO DI APPLICAZIONE / *FOR THE FOLLOWING SCOPE*

EROGAZIONE DI SERVIZI ENERGETICI.

*PROVISION OF ENERGY SERVICES.*

La validità del presente certificato è subordinata a sorveglianza periodica e al riesame completo del sistema con periodicità triennale

*The validity of this certificate is subject to periodic surveillance and to a complete review of the system every three years*

L'uso e la validità del presente certificato sono soggetti al rispetto del documento RINA: Regolamento per l'utilizzo del logotipo RINA.

*The use and validity of this certificate are subject to compliance with the RINA document: Rules for the use of the RINA certifier's logo.*

Prima emissione  
*First Issue* 22.05.2019

Data scadenza  
*Expiry Date* 21.05.2022

Data revisione  
*Revision date* 22.05.2019



PRD N° 002 B

Membro degli Accordi di Mutuo  
Riconoscimento IA, IAF e ILAC  
*Signatory of IA, IAF and ILAC  
Mutual Recognition Agreements*

Giovanni Taormina

Palermo Management System  
Certification, Head

**RINA Services S.p.A.**  
Via Corsica 12 - 16128 Genova Italy



# ICMQ



*IQNet, the association of the world's first class certification bodies, is the largest provider of management System Certification in the world. IQNet is composed of more than 30 bodies and counts over 150 subsidiaries all over the globe.*

## CERTIFICATO CERTIFICATE 21042BIM

SI CERTIFICA CHE IL SISTEMA DI GESTIONE DI  
*WE HEREBY CERTIFY THAT MANAGEMENT SYSTEM OPERATED BY*

### OWAC ENGINEERING COMPANY S.r.l.

Via Resuttana, 360 - 90146 Palermo PA

UNITA' OPERATIVE CERTIFICATE  
*OPERATIONAL CERTIFIED UNITS*

Via Resuttana, 360 - 90146 Palermo PA

E' CONFORME ALLA PRASSI DI RIFERIMENTO  
*IS IN COMPLIANCE WITH REFERENCE PROCEDURE*

### UNI/PdR 74:2019

PER I SEGUENTI TIPI DI PRODOTTI, PROCESSI E SERVIZI  
*COVERING THE FOLLOWING KIND OF PRODUCTS, PROCESSES AND SERVICES*

EA: 34

**progettazione architettonica, strutturale e impiantistica**

**architectural, structural and plant design**

L'uso e la validità del presente certificato sono soggetti al rispetto delle Condizioni Generali di Contratto per la certificazione di sistemi di gestione  
Use and validity of this certificate subject to General Agreement Conditions for certification of management systems

PRIMA EMISSIONE  
*FIRST ISSUE*  
02/08/2021

EMISSIONE CORRENTE  
*CURRENT ISSUE*  
02/08/2021

SCADENZA  
*EXPIRY*  
31/07/2024



Il Presidente e Direttore Generale  
Ing. Lorenzo Orsenigo



SGQ N° 011A  
Membro degli Accordi di Mutuo Riconoscimento EA, IAF e ILAC  
*Signatory of EA, IAF and ILAC Mutual Recognition Agreements*



[www.cisq.com](http://www.cisq.com)

CISQ è la Federazione Italiana di Organismi di Certificazione dei sistemi di gestione aziendale.  
*CISQ is the Italian Federation of management system Certification Bodies.*

ICMQ S.p.A. – Via De Castilia, 10 – 20124 MILANO - [www.icmq.org](http://www.icmq.org) - [icmq@icmq.org](mailto:icmq@icmq.org)







#### **HEADQUARTERS**

##### **ITALY (PALERMO)**

Via Resuttana, 360 - 90146

##### **SENEGAL (DAKAR)**

Mermoz Comico n°64

#### **INTERNATIONAL DESK**

##### **CHINA (SHANGHAI)**

Yunchou Bldg, 1239 Siping  
Road, 200092 Shanghai,  
Repubblica Popolare Cinese

#### **COMMERCIAL DESK**

##### **UAE (DUBAI)**

c/o Sharaf Future Trading  
L.L.C P.O.

Box: 36801, Office No. 1,  
Al Hilal Building, Sheikh  
Rashid Road, Al Garhoud

**PH:** 0039 091 303243

**EMAIL:** [owac@owac.it](mailto:owac@owac.it)

**WEBSITE:** [www.owac.eu](http://www.owac.eu)